

DIN 467 Thin Serrated Knurled Nuts

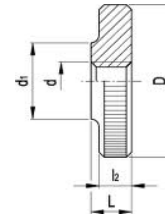

DIN 467 Thin Serrated Knurled Nuts							
Diameter - d	M2.5	M3	M4	M5	M6	M8	M10
D	11	12	16	20	24	30	36
d1	5	6	8	10	12	16	20
L	3	3	4	5	6	8	10
l2	2.5	2.5	3.5	4	5	6	8

Material	
Stainless Steel	A2
Brass - M3 - M10	

INFORMATION AND DRAWINGS PROVIDED ARE REFERENCE ONLY